













KINMORE GREEN ESTATE

STAGE 4



LEGEND

-  Retaining Wall
-  Drainage
-  Footpath
-  Lot Level
-  Street Light
-  Transformer Site
-  Garage Locations
-  Water
-  Traffic Calming
-  Uni Pillar
-  Power
-  No Build Zone
- Refer individual lot plans



Our Ref: 635744 Mar 2026

All Dimensions and areas are subject to survey and the particulars of this plan are supplied for identification purposes only and shall not be taken as a representation in any aspect on the part of the vendor or its agents. Authorities should be consulted when services are contained within lot boundaries as building restrictions may apply. All retaining walls, services and associated easements are shown exaggerated for legibility.

parcel.

KINMORE GREEN ESTATE

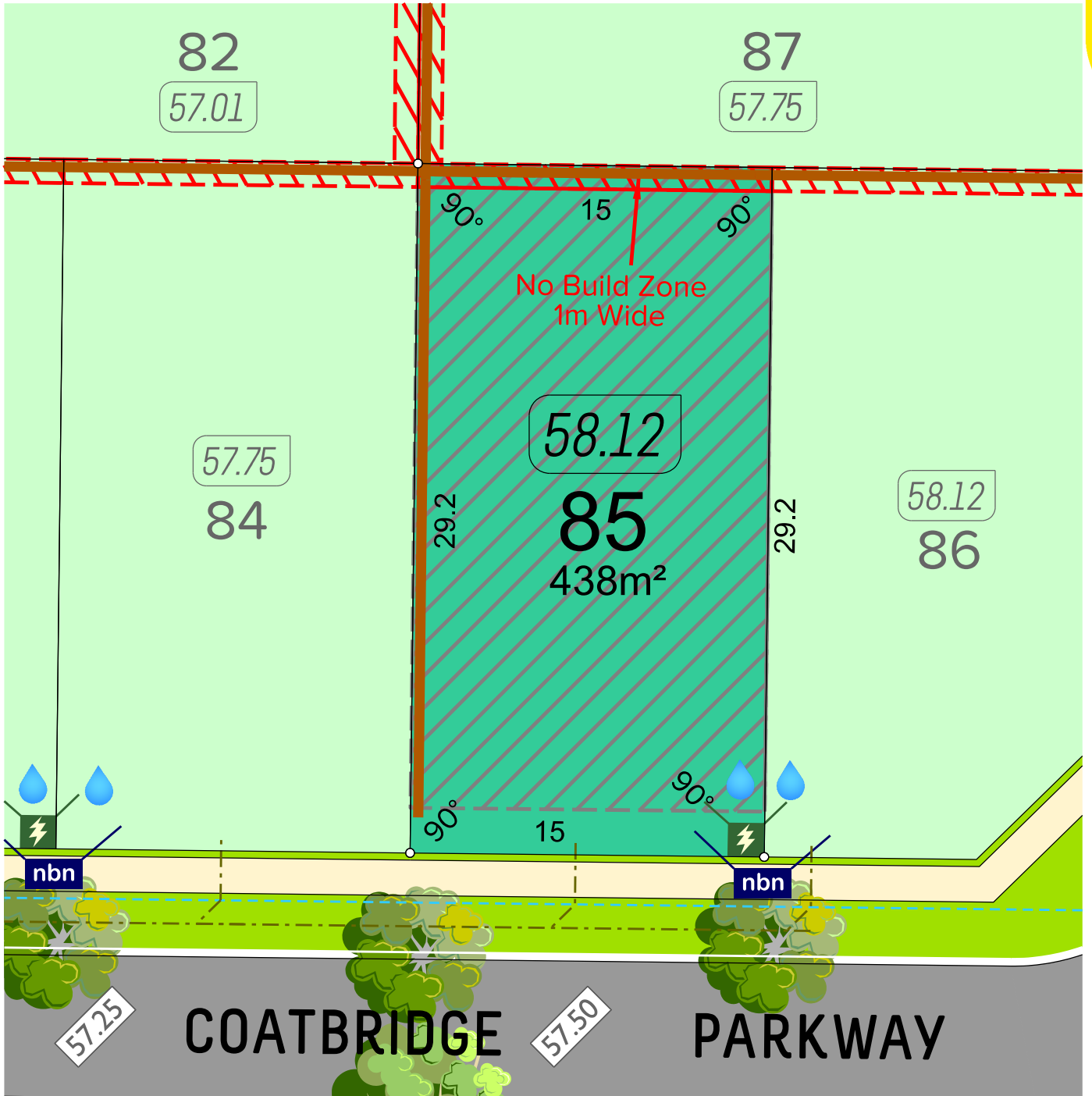

SCALE 1:250

635744 April 2026

- Stairs
- Retaining Wall
- Lot Level
- Footpath

- Vehicle Access Restriction
- Street Light
- Drainage
- Power Dome

- CONNECTION VALVE
- CONNECTION HYDRANT
- MANHOLE CONNECTION

- Garage Locations
- Water Service
- NBN Pit
- Sewer Service

No Build Zone (1m wide). Includes no concrete, paving, or any permanent structure(s). GRMS Extent

kinmoregreen.com.au

*DISCLAIMER- Whilst every care has been taken with the preparation of these particulars, which are believed to be correct, they are in no way warranted by the selling agent or its clients in whole or in part and should not be construed as forming part of any contract. The particulars of this plan are supplied for identification purposes only and shall not be taken as a representation in any aspect on the part of the vendor or its agents. Authorities should be consulted when services are contained within lot boundaries as building restrictions may apply. All retaining walls, services and associated easements are shown exaggerated for legibility. Trees are indicative only. Any intending purchasers are advised to make necessary enquiries to satisfy themselves on all matters in this respect. Sales Agent: Parcel Realty Pty Ltd (ABN 66 153 825 542). Licence number: 64283.

KINMORE GREEN ESTATE

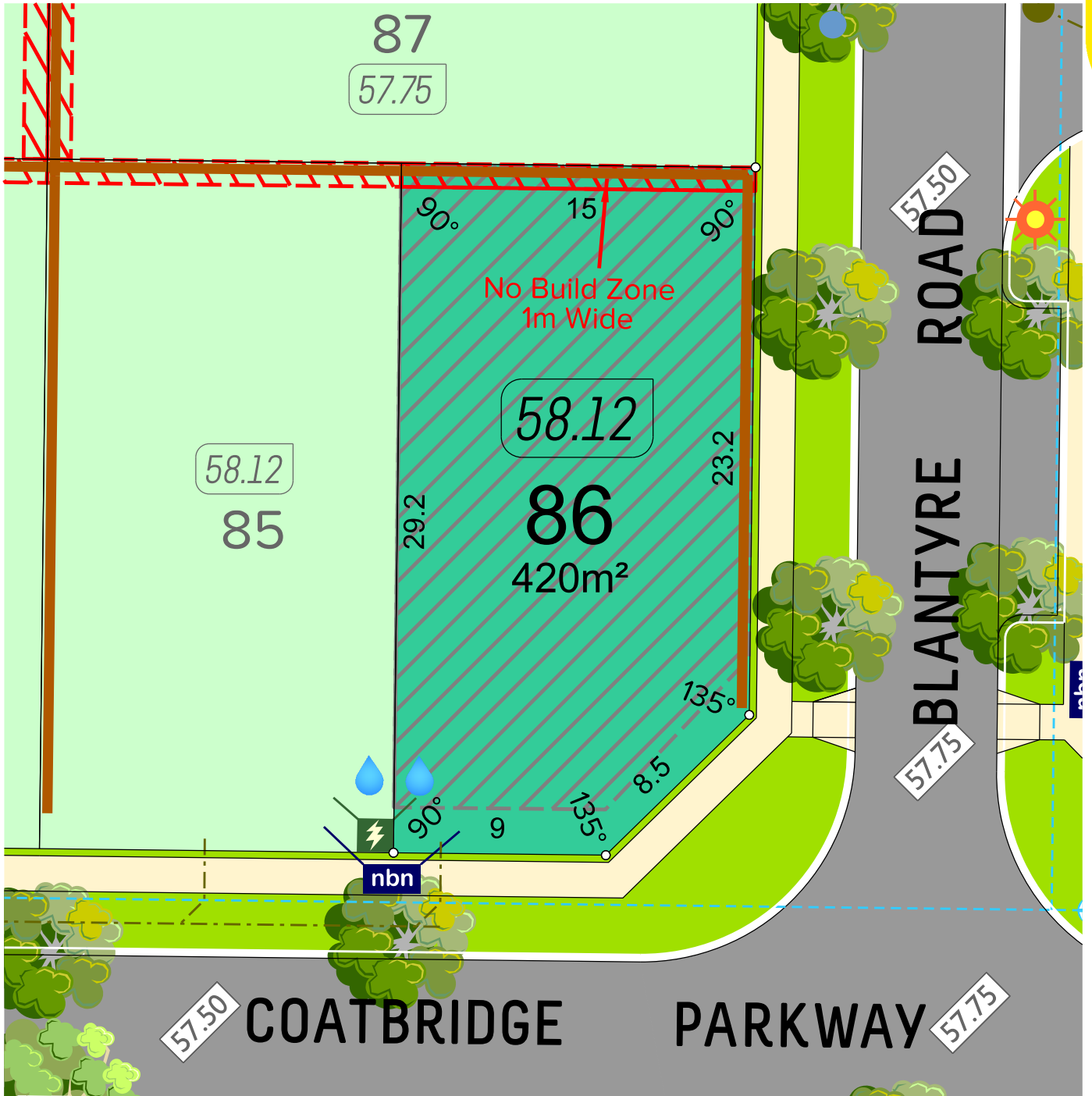

SCALE 1:250 5m

635744 April 2026

- Stairs
- Retaining Wall
- Lot Level
- Footpath

- Vehicle Access Restriction
- Street Light
- Drainage
- Power Dome

- Garage Locations
- Water Service
- NBN Pit
- Sewer Service

No Build Zone (1m wide). Includes no concrete, paving, or any permanent structure(s). GRMS Extent

kinmoregreen.com.au

*DISCLAIMER- Whilst every care has been taken with the preparation of these particulars, which are believed to be correct, they are in no way warranted by the selling agent or its clients in whole or in part and should not be construed as forming part of any contract. The particulars of this plan are supplied for identification purposes only and shall not be taken as a representation in any aspect on the part of the vendor or its agents. Authorities should be consulted when services are contained within lot boundaries as building restrictions may apply. All retaining walls, services and associated easements are shown exaggerated for legibility. Trees are indicative only. Any intending purchasers are advised to make necessary enquiries to satisfy themselves on all matters in this respect. Sales Agent: Parcel Realty Pty Ltd (ABN 66 153 825 542). Licence number: 64283.

parcel.

KINMORE GREEN ESTATE

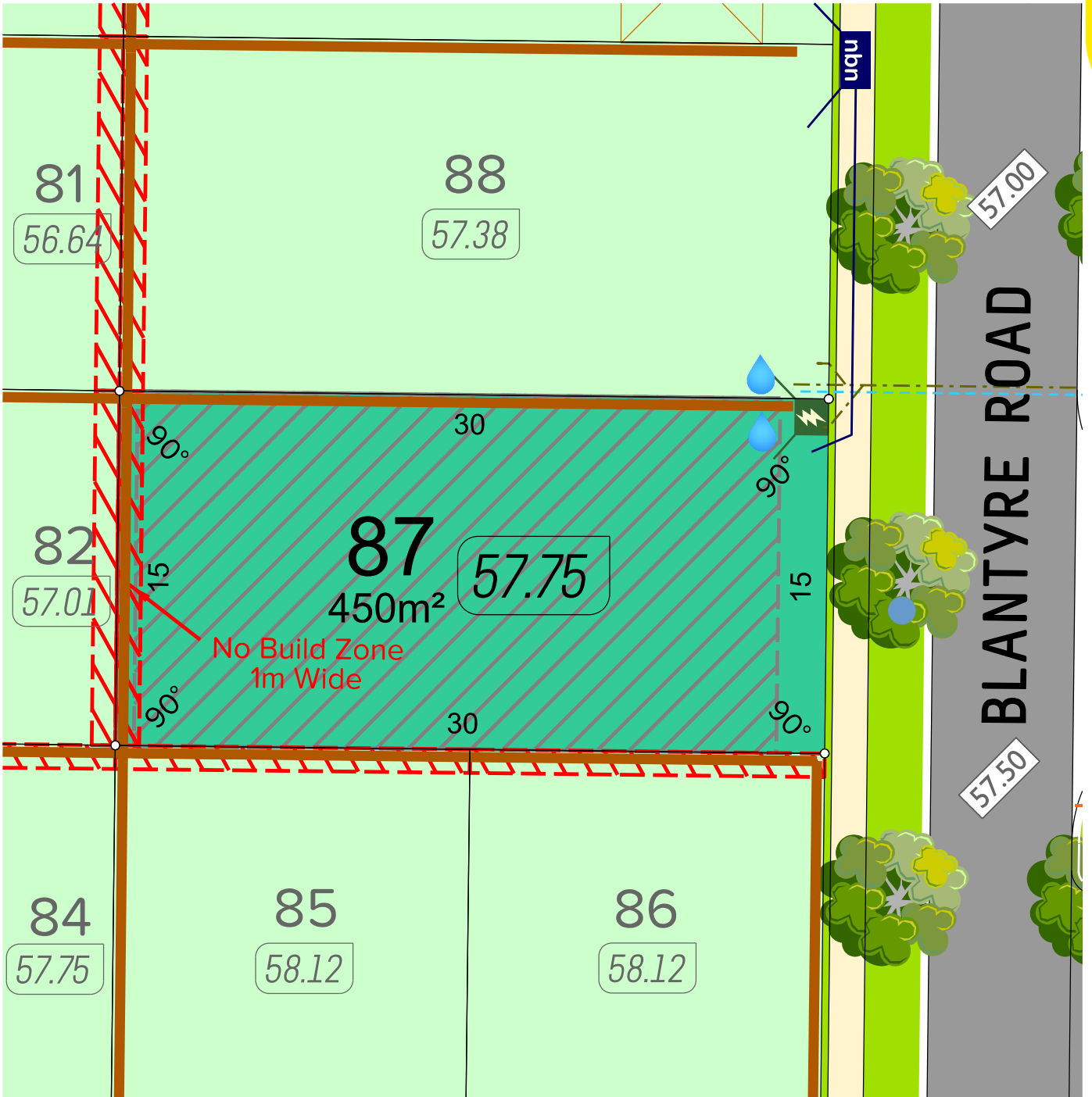

SCALE 1:250

635744 April 2026

- Stairs
- Retaining Wall
- Lot Level
- Footpath

- Vehicle Access Restriction
- Street Light
- Drainage
- Power Dome

- CONNECTION VALVE HYDRANT
- MANHOLE CONNECTION
- nbn
-

- Garage Locations
- Water Service
- NBN Pit
- Sewer Service

No Build Zone (1m wide). Includes no concrete, paving, or any permanent structure(s). GRMS Extent

kinmoregreen.com.au

*DISCLAIMER- Whilst every care has been taken with the preparation of these particulars, which are believed to be correct, they are in no way warranted by the selling agent or its clients in whole or in part and should not be construed as forming part of any contract. The particulars of this plan are supplied for identification purposes only and shall not be taken as a representation in any aspect on the part of the vendor or its agents. Authorities should be consulted when services are contained within lot boundaries as building restrictions may apply. All retaining walls, services and associated easements are shown exaggerated for legibility. Trees are indicative only. Any intending purchasers are advised to make necessary enquiries to satisfy themselves on all matters in this respect. Sales Agent: Parcel Realty Pty Ltd (ABN 66 153 825 542). Licence number: 64283.

KINMORE GREEN ESTATE

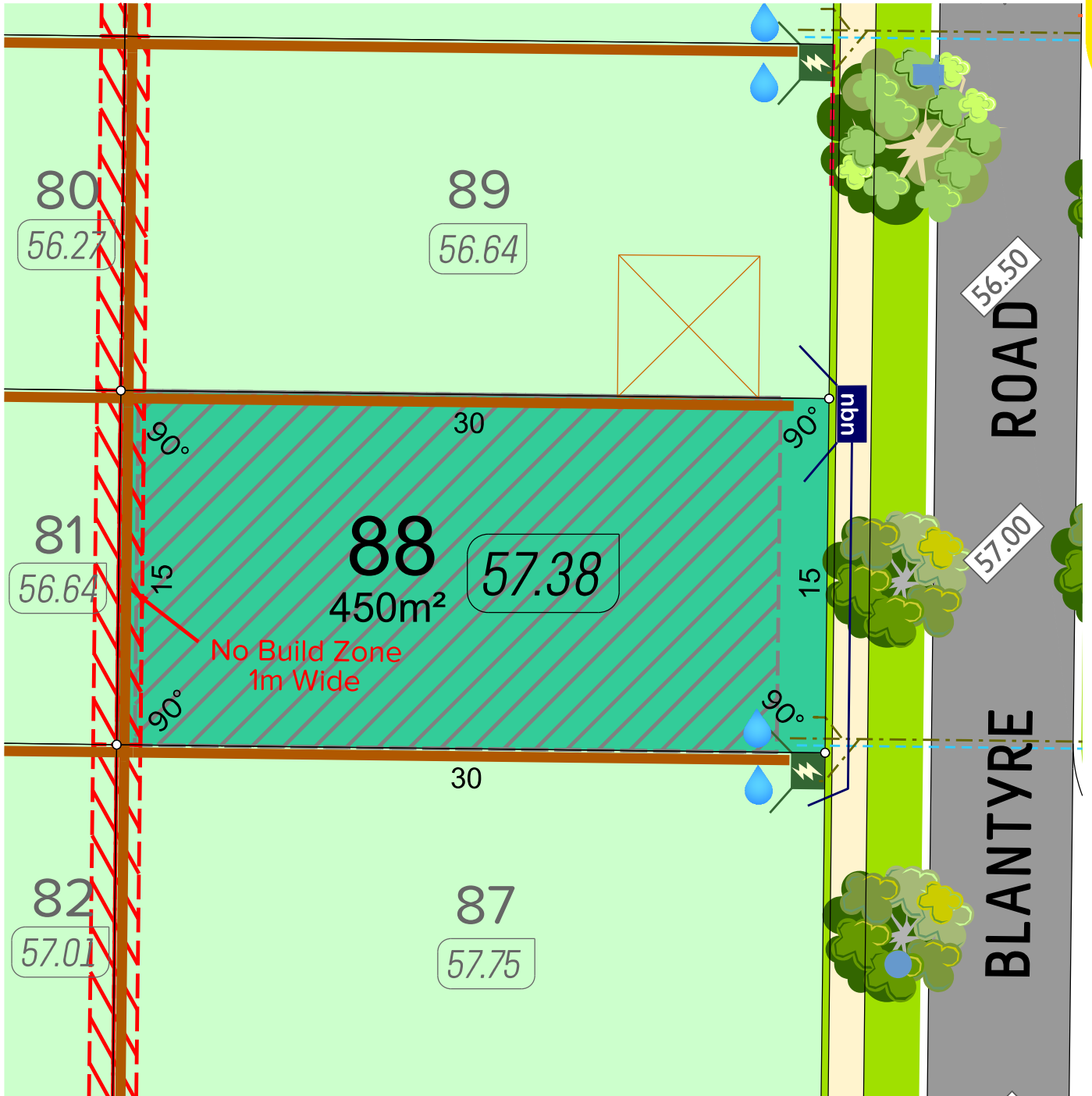

SCALE 1:250

635744 April 2026

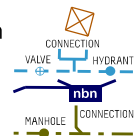

Garage Locations
Water Service
NBN Pit
Sewer Service



No Build Zone (1m wide). Includes no concrete, paving, or any permanent structure(s).



GRMS Extent

kinmoregreen.com.au

*DISCLAIMER- Whilst every care has been taken with the preparation of these particulars, which are believed to be correct, they are in no way warranted by the selling agent or its clients in whole or in part and should not be construed as forming part of any contract. The particulars of this plan are supplied for identification purposes only and shall not be taken as a representation in any aspect on the part of the vendor or its agents. Authorities should be consulted when services are contained within lot boundaries as building restrictions may apply. All retaining walls, services and associated easements are shown exaggerated for legibility. Trees are indicative only. Any intending purchasers are advised to make necessary enquiries to satisfy themselves on all matters in this respect. Sales Agent: Parcel Realty Pty Ltd (ABN 66 153 825 542). Licence number: 64283.

parcel.

KINMORE GREEN ESTATE

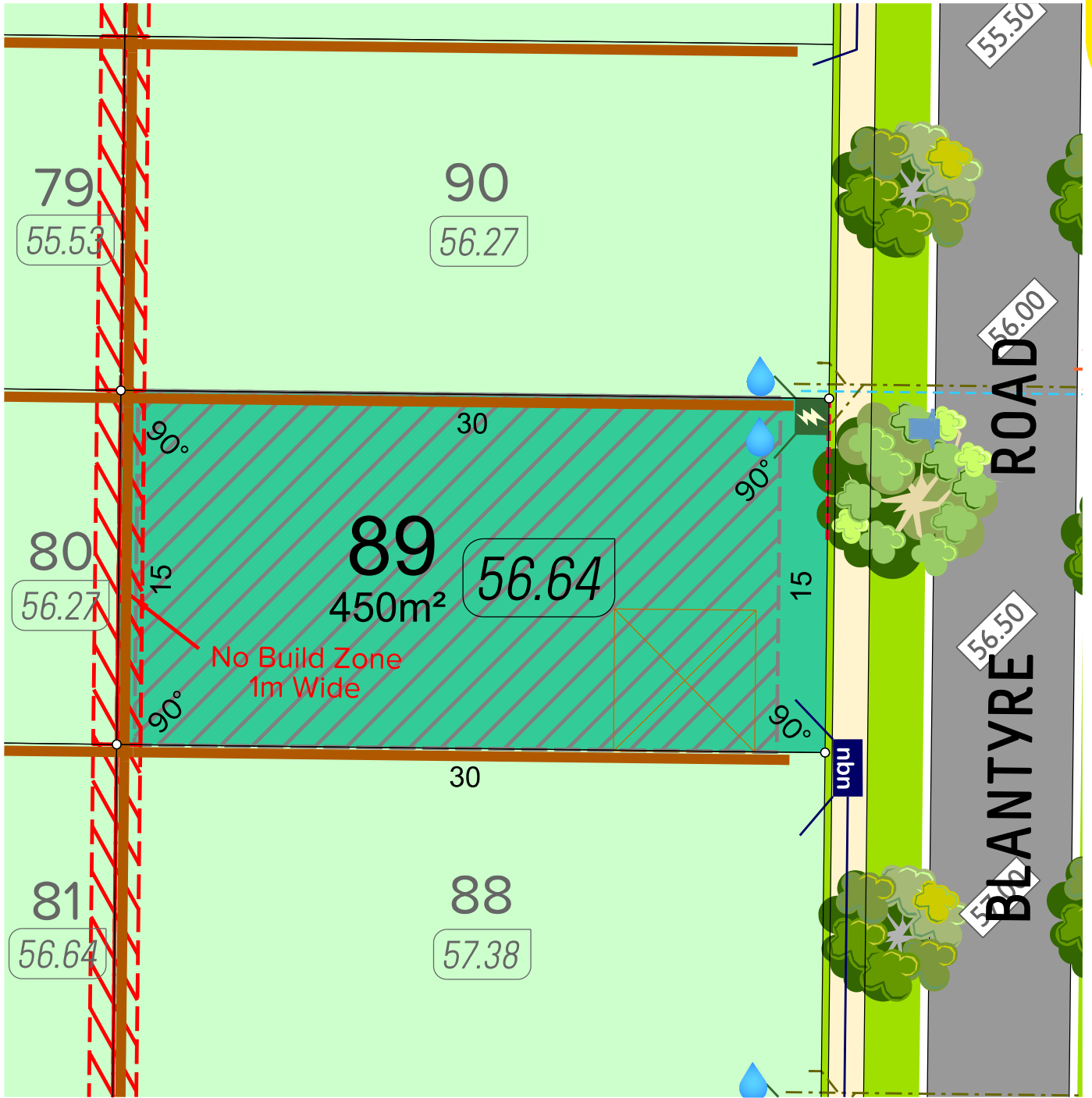

SCALE 1:250

635744 April 2026

- Stairs
- Retaining Wall
- Lot Level
- Footpath

- Vehicle Access Restriction
- Street Light
- Drainage
- Power Dome

- CONNECTION VALVE HYDRANT
- nbn
- MANHOLE CONNECTION
-

- Garage Locations
- Water Service
- NBN Pit
- Sewer Service

No Build Zone (1m wide). Includes no concrete, paving, or any permanent structure(s). GRMS Extent

kinmoregreen.com.au

*DISCLAIMER- Whilst every care has been taken with the preparation of these particulars, which are believed to be correct, they are in no way warranted by the selling agent or its clients in whole or in part and should not be construed as forming part of any contract. The particulars of this plan are supplied for identification purposes only and shall not be taken as a representation in any aspect on the part of the vendor or its agents. Authorities should be consulted when services are contained within lot boundaries as building restrictions may apply. All retaining walls, services and associated easements are shown exaggerated for legibility. Trees are indicative only. Any intending purchasers are advised to make necessary enquiries to satisfy themselves on all matters in this respect. Sales Agent: Parcel Realty Pty Ltd (ABN 66 153 825 542). Licence number: 64283.

parcel.

KINMORE GREEN ESTATE

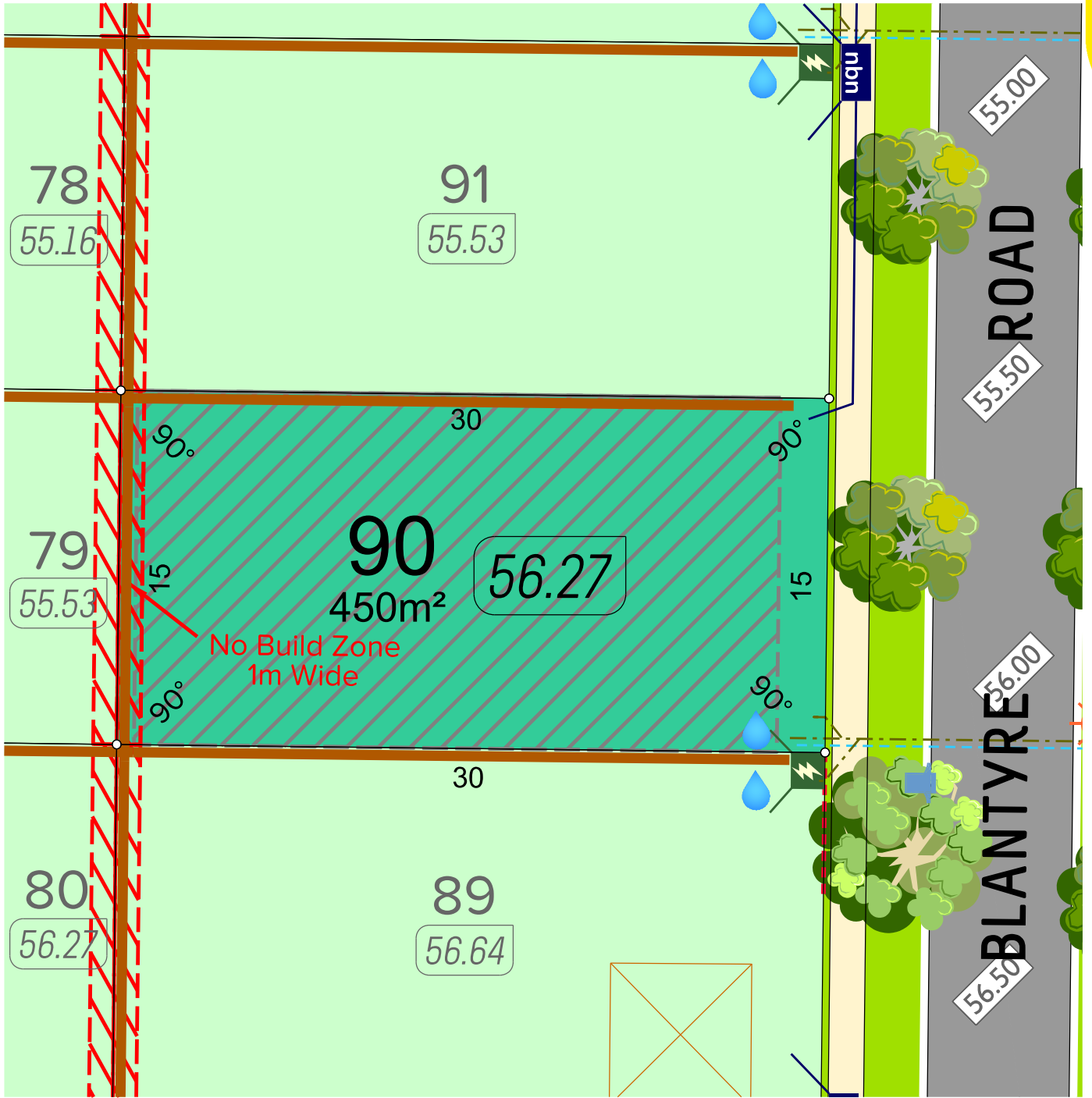

veris



SCALE 1:250

635744 April 2026

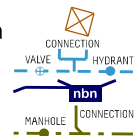
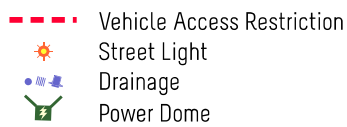

Garage Locations
Water Service
NBN Pit
Sewer Service



No Build Zone (1m wide). Includes no concrete, paving, or any permanent structure(s).



GRMS Extent

kinmoregreen.com.au

*DISCLAIMER- Whilst every care has been taken with the preparation of these particulars, which are believed to be correct, they are in no way warranted by the selling agent or its clients in whole or in part and should not be construed as forming part of any contract. The particulars of this plan are supplied for identification purposes only and shall not be taken as a representation in any aspect on the part of the vendor or its agents. Authorities should be consulted when services are contained within lot boundaries as building restrictions may apply. All retaining walls, services and associated easements are shown exaggerated for legibility. Trees are indicative only. Any intending purchasers are advised to make necessary enquiries to satisfy themselves on all matters in this respect. Sales Agent: Parcel Realty Pty Ltd (ABN 66 153 825 542). Licence number: 64283.

parcel.

KINMORE GREEN ESTATE

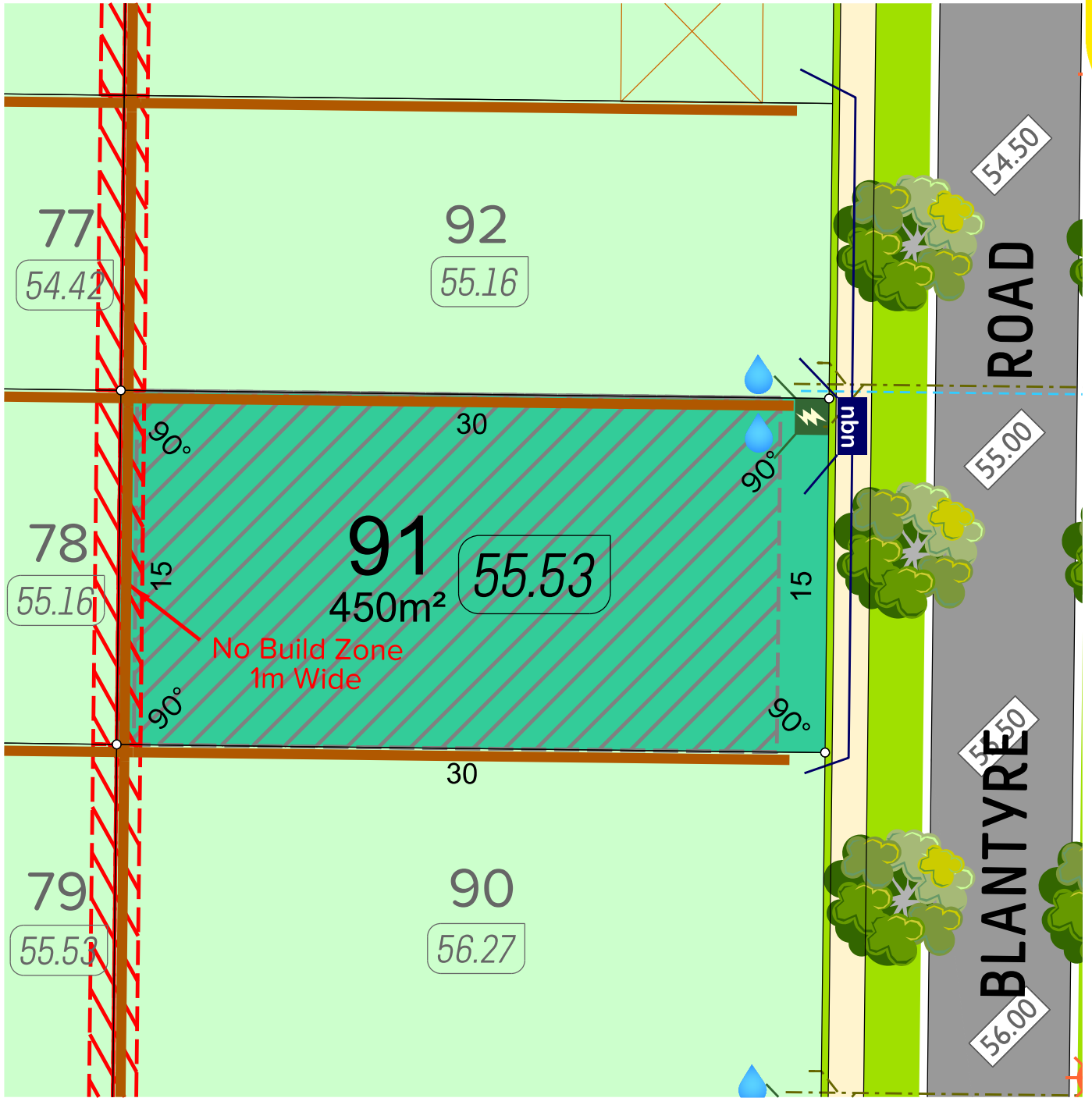

SCALE 1:250

635744 April 2026

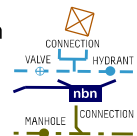
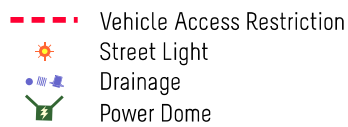

Garage Locations
Water Service
NBN Pit
Sewer Service

No Build Zone (1m wide). Includes no concrete, paving, or any permanent structure(s). GRMS Extent

kinmoregreen.com.au

*DISCLAIMER- Whilst every care has been taken with the preparation of these particulars, which are believed to be correct, they are in no way warranted by the selling agent or its clients in whole or in part and should not be construed as forming part of any contract. The particulars of this plan are supplied for identification purposes only and shall not be taken as a representation in any aspect on the part of the vendor or its agents. Authorities should be consulted when services are contained within lot boundaries as building restrictions may apply. All retaining walls, services and associated easements are shown exaggerated for legibility. Trees are indicative only. Any intending purchasers are advised to make necessary enquiries to satisfy themselves on all matters in this respect. Sales Agent: Parcel Realty Pty Ltd (ABN 66 153 825 542). Licence number: 64283.

parcel.

KINMORE GREEN ESTATE

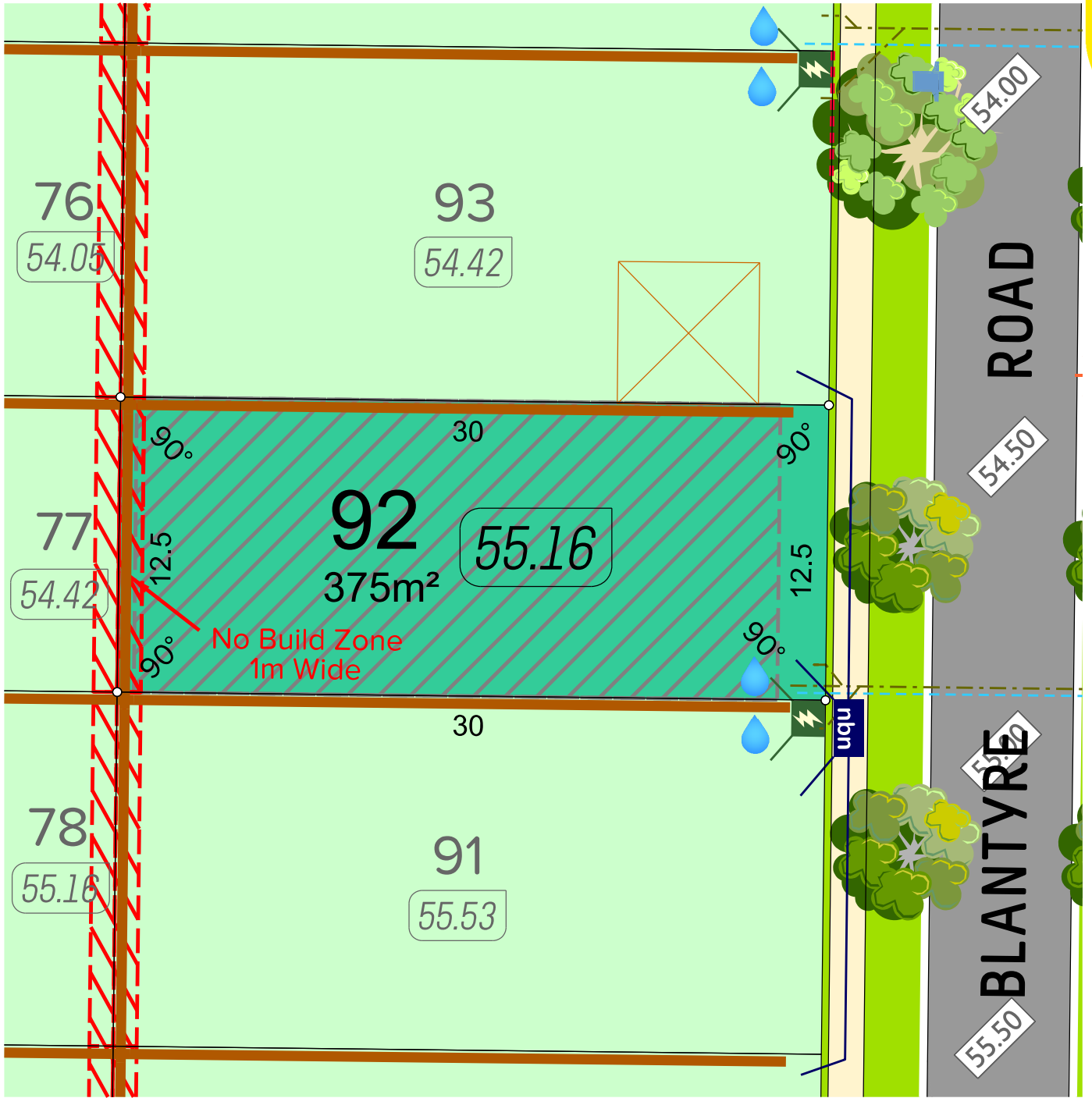

SCALE 1:250

635744 April 2026

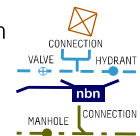

Garage Locations
Water Service
NBN Pit
Sewer Service

No Build Zone (1m wide). Includes no concrete, paving, or any permanent structure(s). GRMS Extent

kinmoregreen.com.au

*DISCLAIMER- Whilst every care has been taken with the preparation of these particulars, which are believed to be correct, they are in no way warranted by the selling agent or its clients in whole or in part and should not be construed as forming part of any contract. The particulars of this plan are supplied for identification purposes only and shall not be taken as a representation in any aspect on the part of the vendor or its agents. Authorities should be consulted when services are contained within lot boundaries as building restrictions may apply. All retaining walls, services and associated easements are shown exaggerated for legibility. Trees are indicative only. Any intending purchasers are advised to make necessary enquiries to satisfy themselves on all matters in this respect. Sales Agent: Parcel Realty Pty Ltd (ABN 66 153 825 542). Licence number: 64283.

parcel.

KINMORE GREEN ESTATE

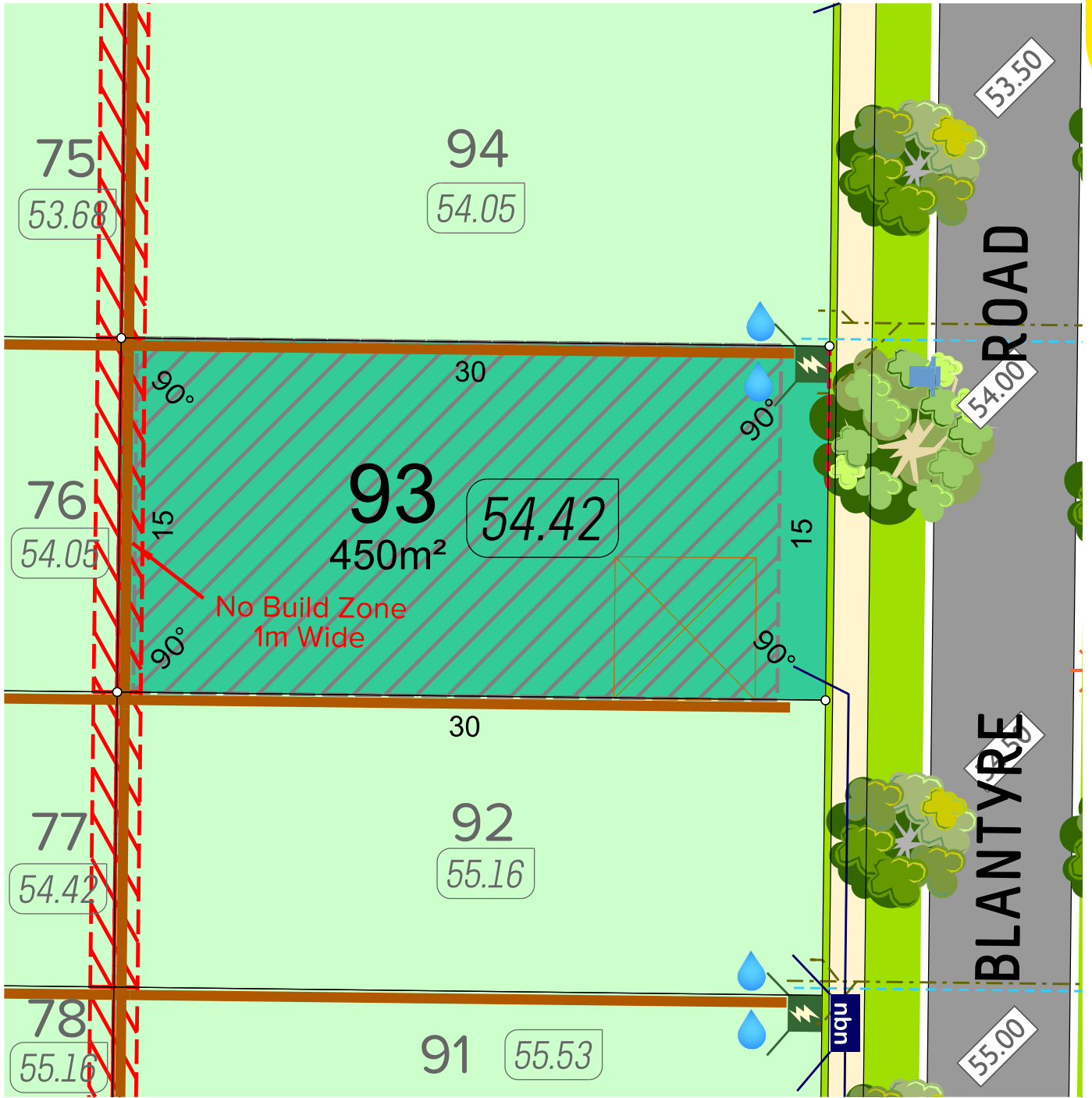

SCALE 1:250

635744 April 2026

- Stairs
- Retaining Wall
- Lot Level
- Footpath

- Vehicle Access Restriction
- Street Light
- Drainage
- Power Dome

- CONNECTION VALVE HYDRANT
- MANHOLE CONNECTION
- nbn
-

- Garage Locations
- Water Service
- NBN Pit
- Sewer Service

No Build Zone (1m wide). Includes no concrete, paving, or any permanent structure(s). GRMS Extent

kinmoregreen.com.au

*DISCLAIMER- Whilst every care has been taken with the preparation of these particulars, which are believed to be correct, they are in no way warranted by the selling agent or its clients in whole or in part and should not be construed as forming part of any contract. The particulars of this plan are supplied for identification purposes only and shall not be taken as a representation in any aspect on the part of the vendor or its agents. Authorities should be consulted when services are contained within lot boundaries as building restrictions may apply. All retaining walls, services and associated easements are shown exaggerated for legibility. Trees are indicative only. Any intending purchasers are advised to make necessary enquiries to satisfy themselves on all matters in this respect. Sales Agent: Parcel Realty Pty Ltd (ABN 66 153 825 542). Licence number: 64283.

parcel.

KINMORE GREEN ESTATE

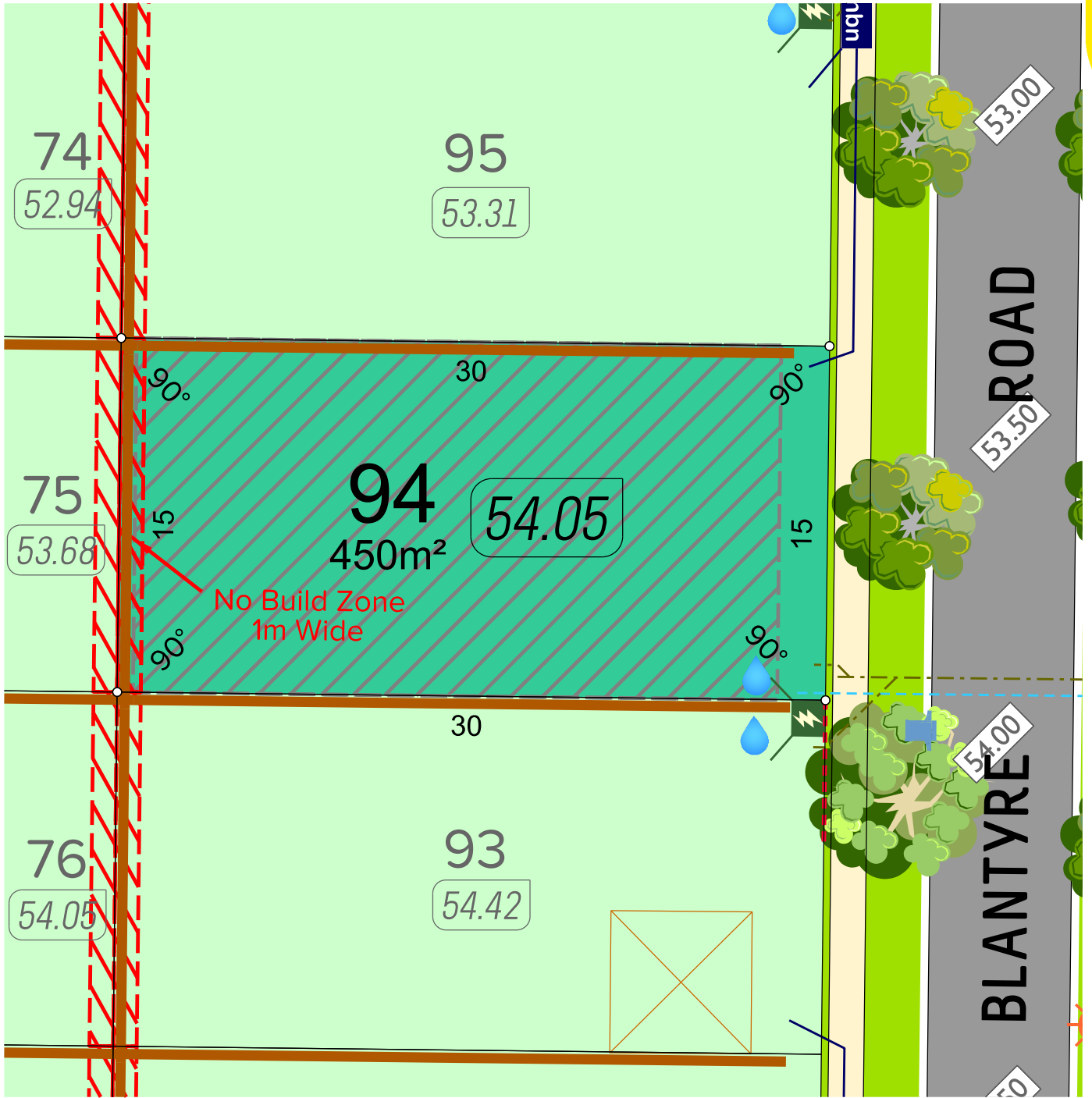

SCALE 1:250

635744 April 2026

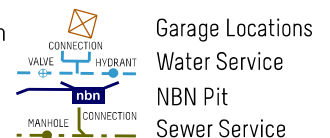

No Build Zone (1m wide). Includes no concrete, paving, or any permanent structure(s). GRMS Extent

kinmoregreen.com.au

*DISCLAIMER- Whilst every care has been taken with the preparation of these particulars, which are believed to be correct, they are in no way warranted by the selling agent or its clients in whole or in part and should not be construed as forming part of any contract. The particulars of this plan are supplied for identification purposes only and shall not be taken as a representation in any aspect on the part of the vendor or its agents. Authorities should be consulted when services are contained within lot boundaries as building restrictions may apply. All retaining walls, services and associated easements are shown exaggerated for legibility. Trees are indicative only. Any intending purchasers are advised to make necessary enquiries to satisfy themselves on all matters in this respect. Sales Agent: Parcel Realty Pty Ltd (ABN 66 153 825 542). Licence number: 64283.

parcel.

KINMORE GREEN ESTATE

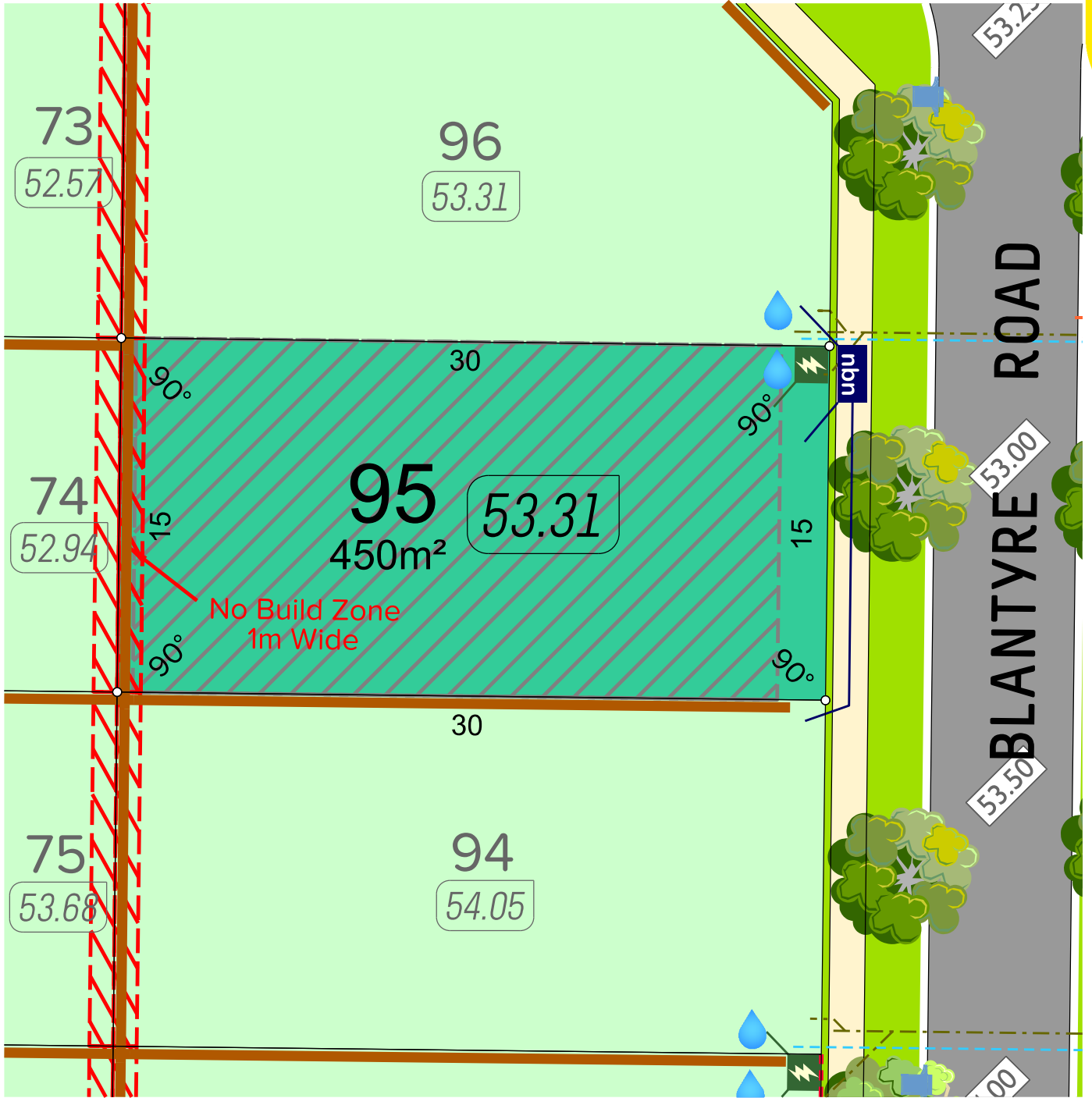

SCALE 1:250 5m

635744 April 2026

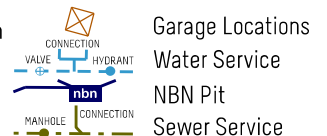
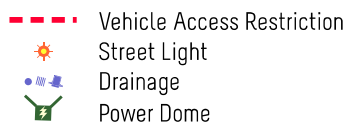

No Build Zone (1m wide). Includes no concrete, paving, or any permanent structure(s). GRMS Extent

kinmoregreen.com.au

*DISCLAIMER- Whilst every care has been taken with the preparation of these particulars, which are believed to be correct, they are in no way warranted by the selling agent or its clients in whole or in part and should not be construed as forming part of any contract. The particulars of this plan are supplied for identification purposes only and shall not be taken as a representation in any aspect on the part of the vendor or its agents. Authorities should be consulted when services are contained within lot boundaries as building restrictions may apply. All retaining walls, services and associated easements are shown exaggerated for legibility. Trees are indicative only. Any intending purchasers are advised to make necessary enquiries to satisfy themselves on all matters in this respect. Sales Agent: Parcel Realty Pty Ltd (ABN 66 153 825 542). Licence number: 64283.

parcel.